

# Installation Instructions & Use Recommendations

## CHP Trainer Instrument Guard for R 1250 R (K53)

These instructions must be read carefully and thoroughly **before** beginning work. FMS Solutions, LLC accepts no liability for damage caused by failure to observe the installation instructions or use recommendations. **Installation of this accessory does not change the factory specified load limits for saddlebags or radio box.**

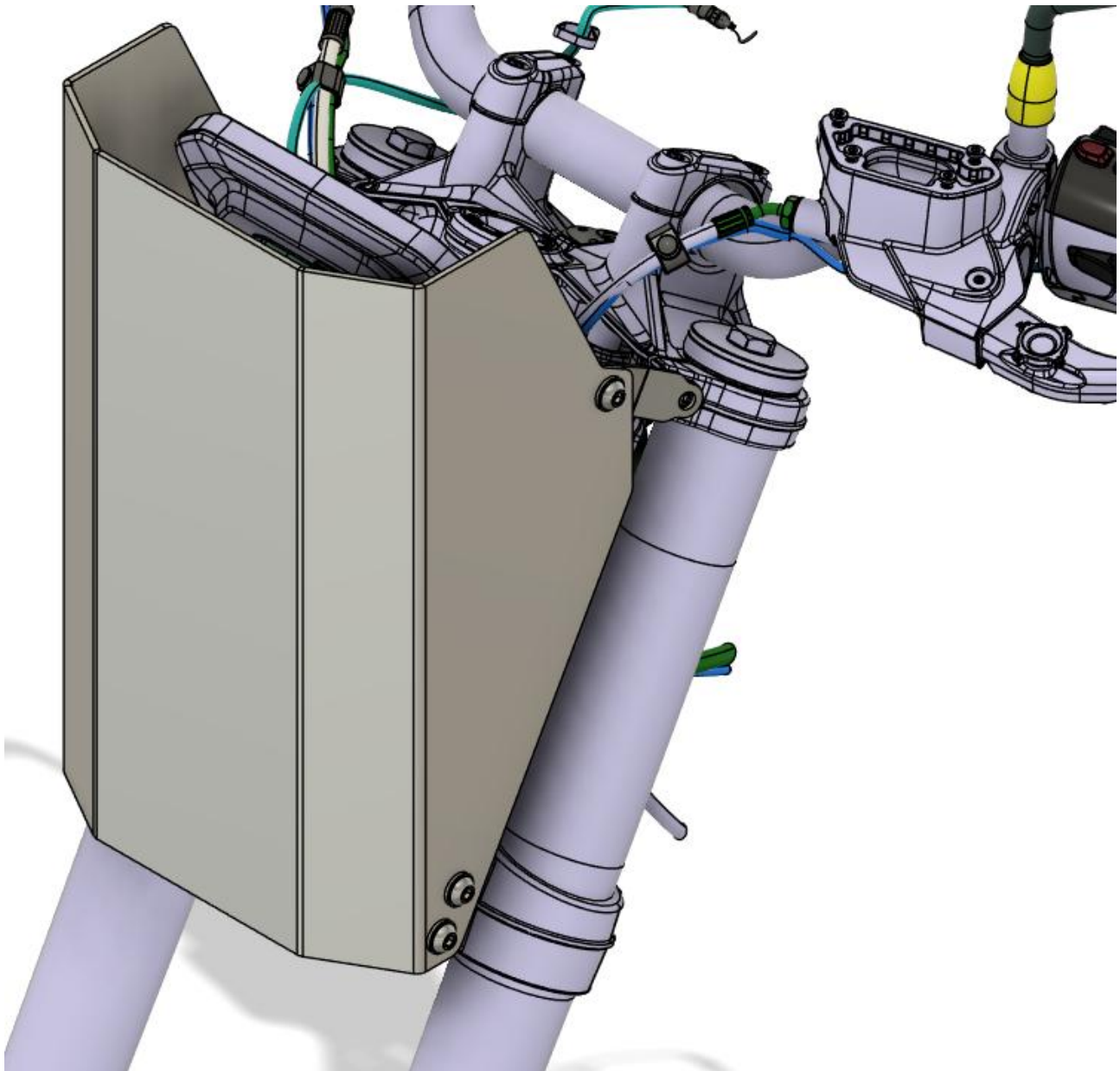

Hardware Included with each kit:

- 6 – M8 x 15 Black Allen Head Bolts
- 6 – M8 Nylock Nuts + Washers
- 2 – M8 x 40 Washer Head Hex Bolts
- 4 – M8 x 45 Hex Bolts + Washers

The guard attaches to the upper and lower triple clamp mounting bolts via adapter brackets.

The bolts will be replaced with longer bolts and spacers to bridge the gap between the undercut on the triple clamp and the adapter brackets.

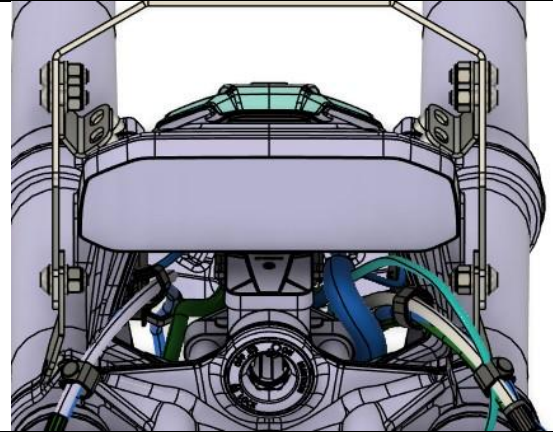

The lower mounting brackets are ambidextrous.

A longer, 12mm spacer is used on the bottom mounts along with M8 x 45mm hex head bolts. Due to the tight nature of the bracket form, the holes are elongated to enable the bolts to be inserted from the side.

Torque pinch bolts per factory specification of 19 Nm 3x each.

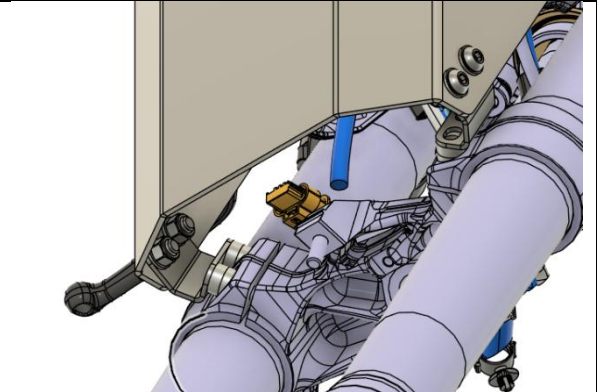

Upper mounting brackets install as shown at right with 6mm spacers and M8 x 40 bolts.

Install guard to brackets with M6 x 15 black bolts and M6 washer head Nylock nuts. Assemble guard to upper and lower brackets and snug bolts prior to final torque application. Torque bolts per factory specification of 19 Nm.

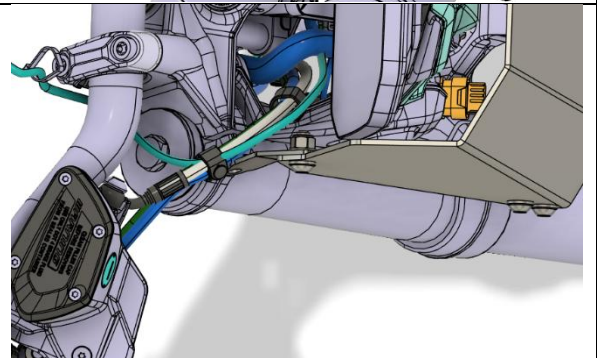

**Feedback:** Thank you for your purchase and we welcome your feedback as we too want to make every accessory exceed your expectations. Report any comments, suggestions, problems or concerns to FMS Solutions, LLC at [info@fmsaccessories.com](mailto:info@fmsaccessories.com).

Thank you!